

# Rotule SA

## BEM16-60-502-DURBAL - BEM16-60-502-DURBAL

<https://www.123roulement.be/roulement-palier/rotule/sa/bem16-60-502-durbal>

### BEM16-60-502



male thread;  
maintenance free,  
adapter sizes  
according to  
DIN ISO 12240-4,  
series K



**DURBAL® heavy-duty rod ends  
with integral spherical  
plain bearing in stainless steel**

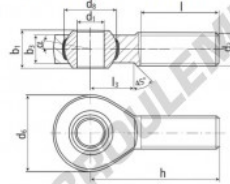

rod end housing:  
stainless steel 1.4301, rolled thread,  
surface with pickling treatment

joint ball:  
stainless steel, hardened and ground,  
surface superfinished

race:  
nylon / teflon / glass fibre compound

tolerances:  
see page 10

order number		measurements [mm]		measurements [mm]		weight		basic load rating	
type	right-hand thread, left-hand thread	d <sub>1</sub>	d <sub>2</sub>	d <sub>4</sub>	d <sub>3</sub>	b <sub>1</sub>	b <sub>2</sub>	C	C <sub>0</sub>
BEM 16 -60	-502	16	M 16	42	28,52	21	15,0		
measurements [mm]		weight		basic load rating		dyn		stat.	
type	h	l	l <sub>3</sub>	α <sub>1</sub> [°]	α <sub>2</sub> [°]	[kg]	[N]	[N]	[N]
BEM 16	66	40	22	15,5	8,5	0,202	13760	37700	

## CARACTÉRISTIQUES PRODUIT

Marque	DURBAL
N° Ean13	3663952509808
Diam. intérieur	16 mm
Diam. extérieur	42 mm
Epaisseur	21 mm
Type	SA
Poids	202 g
Filetage	Filetage à gauche
Lubrification	sans
Conditionnement	1

[contact@123roulement.be](mailto:contact@123roulement.be)

02 808 18 02

CRT4 de Lesquin 60 Rue Du Haut De Sainghin 59273 Fretin FRANCE