

# Rotule SA BEM08-60-501-DURBAL - BEM08-60-501-DURBAL

<https://www.123roulement.be/roulement-palier/rotule/sa/bem08-60-501-durbal>

## BEM08-60-501



male thread;  
maintenance free,  
adapter sizes  
according to  
DIN ISO 12240-4,  
series K

**DURBAL® heavy-duty rod ends  
with integral spherical  
plain bearing in stainless steel**

rod end housing:  
stainless steel 1.4301, rolled thread,  
surface with pickling treatment

joint ball:  
stainless steel, hardened and ground,  
surface superfinished

race:  
nylon / teflon / glass fibre compound

tolerances:  
see page 10

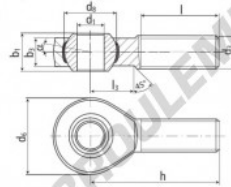

order number		measurements [mm]		weight		basic load rating	
type	right-hand thread	d <sub>1</sub>	d <sub>2</sub>	d <sub>3</sub>	d <sub>4</sub>	C	C <sub>0</sub>
BEM 08 -60	-501	8	M 8	24	15,82	12	9,0
measurements [mm]		weight		basic load rating		stat.	
type	h	l	l <sub>1</sub>	α <sub>1</sub> [°]	α <sub>2</sub> [°]	[N]	[N]
BEM 08	42	25	15	14,5	7,5	0,038	4280 8800

## CARACTÉRISTIQUES PRODUIT

Marque	DURBAL
N° Ean13	3663952509709
Diam. intérieur	8 mm
Diam. extérieur	24 mm
Epaisseur	12 mm
Type	SA
Poids	38 g
Filetage	Filetage à droite
Lubrification	sans
Conditionnement	1

[contact@123roulement.be](mailto:contact@123roulement.be)

02 808 18 02

CRT4 de Lesquin 60 Rue Du Haut De Sainghin 59273 Fretin FRANCE