

Rotule SA EM17-20-501-DURBAL - EM17-20-501-DURBAL

<https://www.123roulement.be/roulement-palier/rotule/sa/em17-20-501-durbal>

EM17-20-501



male thread:
maintenance free,
adapter sizes
according to
DIN ISO 12240-4,
series E / EH



**DURBAL® heavy-duty rod ends
with integral spherical
plain bearing**

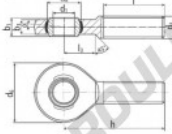

rod end housing:
forged steel, tempered, rolled thread,
surface galvanized, free of Cr VI

joint ball:
ball bearing steel, hardened and ground,
surface superfinished and chromium
plated

race:
nylon / teflon / glass fibre compound

tolerances:
see page 10

order number		measurements [mm]			weight			basic load rating		
type	type	d ₁	d ₃	d ₅	b ₁	b ₃	h	C	C ₀	
EM 17	-20 -501	17	M 16	44	25,0	14	10	69	69	
measurements [mm]		weight			basic load rating		stat.		dyn.	
type	l	b ₃	d ₁ ^h	d ₃ ^h	[kg]	C	C ₀	[N]	[N]	
EM 17	40	23	10,0	5,5	0,163	19200	54100			

CARACTÉRISTIQUES PRODUIT

Marque	DURBAL
N° Ean13	3663952508832
Diam. intérieur	17 mm
Diam. extérieur	44 mm
Epaisseur	14 mm
Type	-
Poids	163 g
Filetage	-
Lubrification	-
Conditionnement	-
Norme	-

contact@123roulement.be

02 808 18 02

CRT4 de Lesquin 60 Rue Du Haut De Sainghin 59273 Fretin FRANCE