

# Rotule SA BEM18-20-502-DURBAL - BEM18-20-502-DURBAL

<https://www.123roulement.be/roulement-palier/rotule/sa/bem18-20-502-durbal>

## BEM18-20-502



male thread:  
maintenance free,  
adapter sizes  
according to  
DIN ISO 12240-4,  
series K



**DURBAL® heavy-duty rod ends  
with integral spherical  
plain bearing**

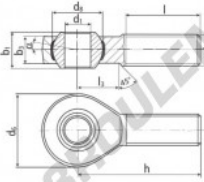

rod end housing:  
forged steel, tempered, rolled thread,  
surface galvanized, free of Cr-VI

joint ball:  
ball bearing steel, hardened and ground,  
surface superfinished and chromium  
plated

race:  
nylon / teflon / glass fibre compound

tolerances:  
see page 10

order number		measurements [mm]		weight		basic load rating	
type	type	d <sub>1</sub>	d <sub>2</sub>	d <sub>3</sub>	d <sub>4</sub>	b <sub>1</sub>	b <sub>2</sub>
BEM 18 -20	-502	18	M 18 x 1,5	46	31,70	23	16,5
measurements [mm]		weight		basic load rating			
type	h	l	l <sub>3</sub>	α <sub>1</sub> °	α <sub>2</sub> °	dyn. C [N]	stat. C <sub>0</sub> [N]
BEM 18	72	44	25	15,0	9,5	0,250	26325 69700

## CARACTÉRISTIQUES PRODUIT

Marque	DURBAL
N° Ean13	3663952507880
Diam. intérieur	18 mm
Diam. extérieur	46 mm
Épaisseur	23 mm
Type	SA
Poids	250 g
Filetage	Filetage à gauche
Lubrification	sans
Conditionnement	1

[contact@123roulement.be](mailto:contact@123roulement.be)

02 808 18 02

CRT4 de Lesquin 60 Rue Du Haut De Sainghin 59273 Fretin FRANCE