

# Rotule TAPR

## GIHR20-DO-DURBAL - GIHR20-DO-DURBAL

<https://www.123roulement.be/roulement-palier/rotule/tapr/gihr20-do-durbal>

### GIHR20-DO



**Description:** Hydraulic rod end. Made of spherical plain bearing DGE...ES pressed into rod end housing. Sliding combination steel / steel, with grease nipple.

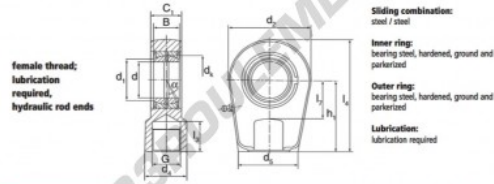

order number	measurement [mm]		measurement [mm]		measurement [mm]		measurement [mm]		measurement [mm]	
right hand thread	d	d <sub>1</sub>	G	d <sub>2</sub>	d <sub>2</sub>	B	C <sub>1</sub>	d <sub>2</sub>	h <sub>1</sub>	h <sub>2</sub>
<b>GIHR 20 DO</b>	20	24,1	M 16 x 1,5	25	46	16	19	56		

type	measurement [mm]		d <sub>1</sub>	load rating	weight
	l <sub>1</sub> min	l <sub>2</sub> min	h <sub>1</sub>	C <sub>0</sub> [kN]	[kg]
<b>GIHR / GIHL 20 DO</b>	17	25	50	80,0	29,0
					9
					72
					0,43

## CARACTÉRISTIQUES PRODUIT

Marque	DURBAL
N° Ean13	3663952499505
Diam. intérieur	20 mm
Diam. extérieur	56 mm
Épaisseur	19 mm
Type	TAPR
Poids	430 g
Filetage	Filetage à droite
Lubrification	avec
Conditionnement	1

[contact@123roulement.be](mailto:contact@123roulement.be)

02 808 18 02

CRT4 de Lesquin 60 Rue Du Haut De Sainghin 59273 Fretin FRANCE