

# Rotule SA SA50-ES-2RS-DURBAL - SA50-ES-2RS-DURBAL

<https://www.123roulement.be/roulement-palier/rotule/sa/sa50-es-2rs-durbal>

## SA50-ES-2RS



male thread:  
lubrication  
is necessary,  
according to  
DIN ISO 12240-4,  
series E

**Description:** DIN ISO rod end E series. Made of spherical plain bearing DGE...E (ES) pressed into rod end body. Sliding combination steel / steel. Maintenance necessary. Bore diameter  $d \geq 15$  with grease nipple in rod end body and lubrication groove and hole in inner and outer ring. Bore diameter  $d \geq 15$  type DSA...ES-2RS with additional seals also available.

rod end body:  
surface zinc plated

Sliding combination:  
steel / steel

Inner ring:  
bearing steel, hardened, ground and phosphated

Outer ring:  
bearing steel, hardened, ground and phosphated

Lubrication:  
lubrication is necessary

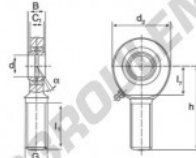

order number		measurement [mm]				
right hand thread	left hand thread	d	G	B	C <sub>1</sub>	d <sub>2</sub>
SA 50 ES (-2RS)		50	M 45 x 3	35	30,0	112

type	measurement [mm]				n [°]	load rating C <sub>0</sub> [kN]	weight [kg]
	l <sub>1</sub> min	l <sub>2</sub>	h				
SA / SAL 50 ES (-2RS)	107	56	185		6	290,0	3,400

## CARACTÉRISTIQUES PRODUIT

Marque	DURBAL
N° Ean13	3663952498669
Diam. intérieur	50 mm
Diam. extérieur	112 mm
Epaisseur	35 mm
Type	SA
Poids	3400 g
Filetage	Filetage à droite
Lubrification	avec
Conditionnement	1

[contact@123roulement.be](mailto:contact@123roulement.be)

02 808 18 02

CRT4 de Lesquin 60 Rue Du Haut De Sainghin 59273 Fretin FRANCE