

Rotule SA SAL35-ES-DURBAL - SAL35-ES-DURBAL

<https://www.123roulement.be/roulement-palier/rotule/sa/sal35-es-durbal>

SAL35-ES



male thread:
lubrication
is necessary,
according to
DIN ISO 12240-4,
series E

Description: DIN ISO rod end E series. Made of spherical plain bearing DGE...E (ES) pressed into rod end body. Sliding combination steel / steel. Maintenance necessary. Bore diameter $d \geq 15$ with grease nipple in rod end body and lubrication groove and hole in inner and outer ring. Bore diameter $d \geq 15$ type DSA...ES-2RS with additional seals also available.

rod end body:
surface zinc plated

Sliding combination:
steel / steel

Inner ring:
bearing steel, hardened, ground and phosphated

Outer ring:
bearing steel, hardened, ground and phosphated

Lubrication:
lubrication is necessary

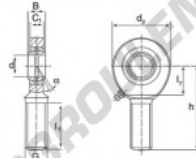

order number		measurement [mm]				
right hand thread	left hand thread	d	G	B	C ₁	d ₂
	SAL 35 ES	35	M 36 x 3	25	21,0	82

type	measurement [mm]				n [°]	load rating C ₀ [kN]	weight [kg]
	l ₁ min	l ₂	h				
SA / SAL 35 ES	82	41	140	6	6	146,0	1,400

CARACTÉRISTIQUES PRODUIT

Marque	DURBAL
N° Ean13	3663952498430
Diam. intérieur	35 mm
Diam. extérieur	82 mm
Epaisseur	25 mm
Type	SA
Poids	1400 g
Filetage	Filetage à gauche
Lubrification	avec
Conditionnement	1

contact@123roulement.be

02 808 18 02

CRT4 de Lesquin 60 Rue Du Haut De Sainghin 59273 Fretin FRANCE