

Rotule SA SA10-E-DURBAL - SA10-E-DURBAL

<https://www.123roulement.be/roulement-palier/rotule/sa/sa10-e-durbal>

SA10-E



male thread:
lubrication
is necessary,
according to
DIN ISO 12240-4,
series E

Description: DIN ISO rod end E series. Made of spherical plain bearing DGE...E (ES) pressed into rod end body. Sliding combination steel / steel. Maintenance necessary. Bore diameter $d \geq 15$ with grease nipple in rod end body and lubrication groove and hole in inner and outer ring. Bore diameter $d \geq 15$ type DSA...ES-2RS with additional seals also available.

rod end body:
surface zinc plated

Sliding combination:
steel / steel

Inner ring:
bearing steel, hardened, ground and phosphated

Outer ring:
bearing steel, hardened, ground and phosphated

Lubrication:
lubrication is necessary

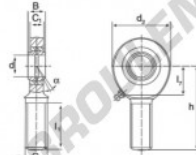

order number		measurement [mm]				
right hand thread	left hand thread	d	G	B	C ₁	d ₂
SA 10 E		10	M 10	9	7,0	29
type	l ₁ min	l ₂	h	n [°]	load rating C ₀ [kN]	weight [kg]
SA / SA 10 E	26	15	48	12	17,6	0,051

CARACTÉRISTIQUES PRODUIT

Marque	DURBAL
N° Ean13	3663952497945
Diam. intérieur	10 mm
Diam. intérieur	0.394" inch
Diam. extérieur	29 mm
Diam. extérieur	1.142" inch
Epaisseur	9 mm
Epaisseur	0.354" inch
Type	SA
Poids	51 g
Filetage	Filetage à droite
Lubrification	avec
Conditionnement	1

contact@123roulement.be

02 808 18 02

CRT4 de Lesquin 60 Rue Du Haut De Sainghin 59273 Fretin FRANCE