

Rotule SA SA40-T-K-DURBAL - SA40-T-K-DURBAL

<https://www.123roulement.be/roulement-palier/rotule/sa/sa40-t-k-durbal>

SA40-T-K



male thread;
maintenance free,
according to
DIN ISO 12240-4,
series K



Description: DIN ISO rod end K series. Made of spherical plain bearing DG...PW pressed into rod end body. Sliding combination steel / bronze-PTFE composite.

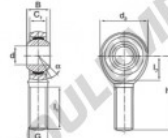

Rod end body:
surface zinc plated

Sliding combination:
steel / bronze-PTFE composite

Inner ring:
bearing steel, hardened, ground and
spherical surface chromium plated

Outer ring:
brass body pressed around, outer race
lined with bronze-PTFE composite

Lubrication:
maintenance free

order number	measurement [mm]				
	d	G	B	C ₁	d ₂
SA 40 T/K	40	M 42 x 2	49	33,00	91

type	measurement [mm]				Tragzahlen C ₁₀ [kN]	weight [kg]
	l ₁ min	l ₂	h	α [°]		
SA / SAL 40 T/K	90	46	150	17		2,300

CARACTÉRISTIQUES PRODUIT

Marque	DURBAL
N° Ean13	3663952490458
Diam. intérieur	40 mm
Diam. extérieur	91 mm
Epaisseur	49 mm
Type	SA
Poids	2300 g
Filetage	Filetage à droite
Lubrification	sans
Conditionnement	1

contact@123roulement.be

02 808 18 02

CRT4 de Lesquin 60 Rue Du Haut De Sainghin 59273 Fretin FRANCE