

Rotule SA

SA30-T-K-DURBAL - DSA30-T-K-DURBAL

https://www.123roulement.be/roulement-palier/rotule/sa/dsa30-t-k-durbal

SA30-T-K



male thread; maintenance free, according to DIN ISO 12240-4, series K



Description: DIN ISO rod end K series. Made of spherical plain bearing DG...PW pressed into rod end body. Sliding combination steel / bronze-PTFE composite.

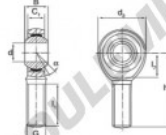

Rod end body: surface zinc plated

Sliding combination: steel / bronze-PTFE composite

Inner ring: bearing steel, hardened, ground and spherical surface chromium plated

Outer ring: brass body pressed around, outer race lined with bronze-PTFE composite

Lubrication: maintenance free

order number	measurement [mm]		C ₁	d ₂
	d	G		
SA 30 T/K	30	M 30 x 2	37	25,00

type	measurement [mm]		h	alpha [°]	Tragzahlen C ₁₀ [kN]	weight [kg]
	l ₁ min	l ₂				
SA / SAI 30 T/K	66	35	110	17	114,0	1,100

CARACTÉRISTIQUES PRODUIT

Marque	DURBAL
N° Ean13	3663952490373
Diam. intérieur	30 mm
Diam. extérieur	70 mm
Epaisseur	37 mm
Type	SA
Poids	1100 g
Filetage	Filetage à droite
Lubrification	sans
Conditionnement	1

contact@123roulement.be

02 808 18 02

CRT4 de Lesquin 60 Rue Du Haut De Sainghin 59273 Fretin FRANCE