

Rotule SA SAL8-T-K-DURBAL - SAL8-T-K-DURBAL

https://www.123roulement.be/roulement-palier/rotule/sa/sal8-t-k-durbal

SAL8-T-K



male thread;
maintenance free,
according to
DIN ISO 12240-4,
series K



Description: DIN ISO rod end K series. Made of spherical plain bearing DG...PW pressed into rod end body. Sliding combination steel / bronze-PTFE composite.

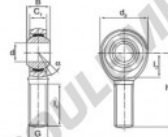

Rod end body:
surface zinc plated

Sliding combination:
steel / bronze-PTFE composite

Inner ring:
bearing steel, hardened, ground and
spherical surface chromium plated

Outer ring:
brass body pressed around, outer race
lined with bronze-PTFE composite

Lubrication:
maintenance free

order number		measurement [mm]		Tragzahlen		weight
right hand thread	left hand thread	d	G	B	C ₁	d ₂
SAL 8 T/K		8	M 8	12	9,00	24
type	l ₁ min	measurement [mm]		h	alpha [°]	weight [kg]
SA / SAL 8 T/K	25			42	14	0,038

CARACTÉRISTIQUES PRODUIT

Marque	DURBAL
N° Ean13	3663952490007
Diam. intérieur	8 mm
Diam. intérieur	0.315" inch
Diam. extérieur	24 mm
Diam. extérieur	0.945" inch
Epaisseur	12 mm
Epaisseur	0.472" inch
Type	SA
Poids	38 g
Filetage	Filetage à gauche
Lubrification	sans
Conditionnement	-
Norme	Sans norme

contact@123roulement.be

02 808 18 02

CRT4 de Lesquin 60 Rue Du Haut De Sainghin 59273 Fretin FRANCE