

# Rotule SI

## SIL30M27X2-T-K-DURBAL - SIL30M27X2-T-K-DURBAL

<https://www.123roulement.be/roulement-palier/rotule/si/sil30m27x2-t-k-durbal>

### SIL30M27X2-T-K



female thread:  
maintenance free,  
according to  
DIN ISO 12240-4,  
series K



Description: DIN ISO rod end K series. Made of spherical plain bearing DG...PW pressed into rod end body. Sliding combination steel / bronze-PTFE composite.

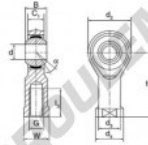

rod end body:  
surface zinc plated

Sliding combination:  
steel / bronze-PTFE composite

inner ring:  
bearing steel, hardened, ground and  
spherical surface chromium plated

outer ring:  
brass body pressed around, outer race  
lined with bronze-PTFE composite

Lubrication:  
maintenance free

order number		measurement (mm)						
right hand thread	left hand thread	d	G	B	C <sub>1</sub>	d <sub>2</sub>	d <sub>3</sub>	d <sub>4</sub>
	SIL 30 T/K M 27 x 2	30	M 27 x 2	37	25,00	70	40,0	50
type	measurement (mm)		h	d <sub>1</sub>	load rating C <sub>0</sub> (N)	weight (kg)		
SI / SIL 30 T/K M 27 x 2	l <sub>1</sub> min	W	h	d <sub>1</sub>	PT			
	51	41	110	17	114,0	1,100		

## CARACTÉRISTIQUES PRODUIT

Marque	DURBAL
N° Ean13	3663952489735
Diam. intérieur	30 mm
Diam. extérieur	70 mm
Epaisseur	37 mm
Type	SI
Poids	1100 g
Filetage	Filetage à gauche
Lubrification	sans
Conditionnement	1

[contact@123roulement.be](mailto:contact@123roulement.be)

02 808 18 02

CRT4 de Lesquin 60 Rue Du Haut De Sainghin 59273 Fretin FRANCE