

## Rotule SI

### SI14-T-K-DURBAL - SI14-T-K-DURBAL

<https://www.123roulement.be/roulement-palier/rotule/si/si14-t-k-durbal>

#### SI14-T-K



female thread:  
maintenance free,  
according to  
DIN ISO 12240-4,  
series K



**Description:** DIN ISO rod end K series. Made of spherical plain bearing DG...PW pressed into rod end body. Sliding combination steel / bronze-PTFE composite.

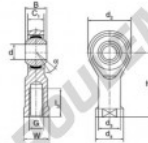

**Rod end body:**  
surface zinc plated

**Sliding combination:**  
steel / bronze-PTFE composite

**Inner ring:**  
bearing steel, hardened, ground and spherical surface chromium plated

**Outer ring:**  
brass body pressed around, outer race lined with bronze-PTFE composite

**Lubrication:**  
maintenance free

order number		measurement [mm]						
right hand thread	left hand thread	d	G	B	C <sub>1</sub>	d <sub>2</sub>	d <sub>3</sub>	d <sub>4</sub>
SI 14 TIK		14	M 14	19	13,50	36	20,0	25

type	measurement [mm]			load rating C <sub>10</sub> [N]	weight [kg]
	l <sub>1</sub> min	W	h		
SI / SIL 14 TIK	25	22	57	16	0,160

## CARACTÉRISTIQUES PRODUIT

Marque	DURBAL
N° Ean13	3663952489353
Diam. intérieur	14 mm
Diam. intérieur	0.551" inch
Diam. extérieur	36 mm
Diam. extérieur	1.417" inch
Epaisseur	19 mm
Epaisseur	0.748" inch
Type	SI
Poids	160 g
Filetage	Filetage à droite
Lubrification	sans
Conditionnement	1

[contact@123roulement.be](mailto:contact@123roulement.be)

02 808 18 02

CRT4 de Lesquin 60 Rue Du Haut De Sainghin 59273 Fretin FRANCE